

Bundle Address Labeller 440



The Bundle Address Labeller plays the part of the mailroom's postal service assistant: An on-line labeller that automatically prints and applies bundle identification labels to the final newspaper bundles, this unflagging maintainer of efficiency is normally referred to as BAL 440, for the sake of simplicity.

BAL 440

– Efficiency features

The BAL 440 is an on-line bundle address labeller that automatically prints and applies bundle identification labels to the newspaper bundles.

The BAL is equipped with a thermal printer, which is fed directly from a paper roll. The label is cut from the roll in whatever label size is required by the customer. The label layout is uploaded to the printer by the overall control system. The printer can handle different fonts and barcodes as well as unique customer logos.

The label includes all the information necessary to effectuate an efficient bundle distribution. Via the bundle label the bundle can be individually tracked and controlled through the mailroom operation to the loading bay area and onto the right truck or pick-up point.

The bundle label information such as name and address of recipient, route information, number of copies, information to the distributors, etc. can be loaded from the Schur TMS Production System or via interface onto a third party system. Furthermore, it is possible to load simple production information to the printer memory in case of stand-alone configuration.

Special features:

- User-friendly operator interface
- Easy to access and easy to maintain
- Integrated part of the Schur TMS production system
- Prints on continuous paper web

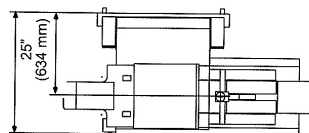
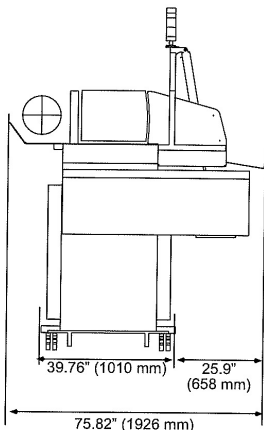

Technical specifications

CAPACITY:

Approximately 30 labels per minute
(depends on label data complexity)

BUNDLE HEIGHT:

Max: 450 mm (17")

Min: 1 product

PRINT METHOD:

Direct thermal printing

PAPER QUALITY:

Kanzan KF-606 or similar quality

LABEL ROLL DIAMETER:

Max: 410 mm (16")

LABEL WIDTH:

Max: 216 mm (8,5")

Min: 170 mm (6,7")

LABEL LENGTH:

Max: 300 mm (12")

Min: 150 mm (6")

DATA INTERFACE:

Schur TMS production systems

